

LEGEND

- EXISTING 10 FOOT CONTOUR
- EXISTING TREELINE
- PROPOSED GRADING LIMIT
- STREAM
- PROPOSED 10 FOOT CONTOUR
- WETLAND

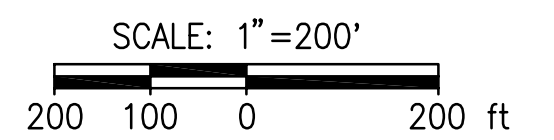

**PROGRESS PRINT**  
15FEB06

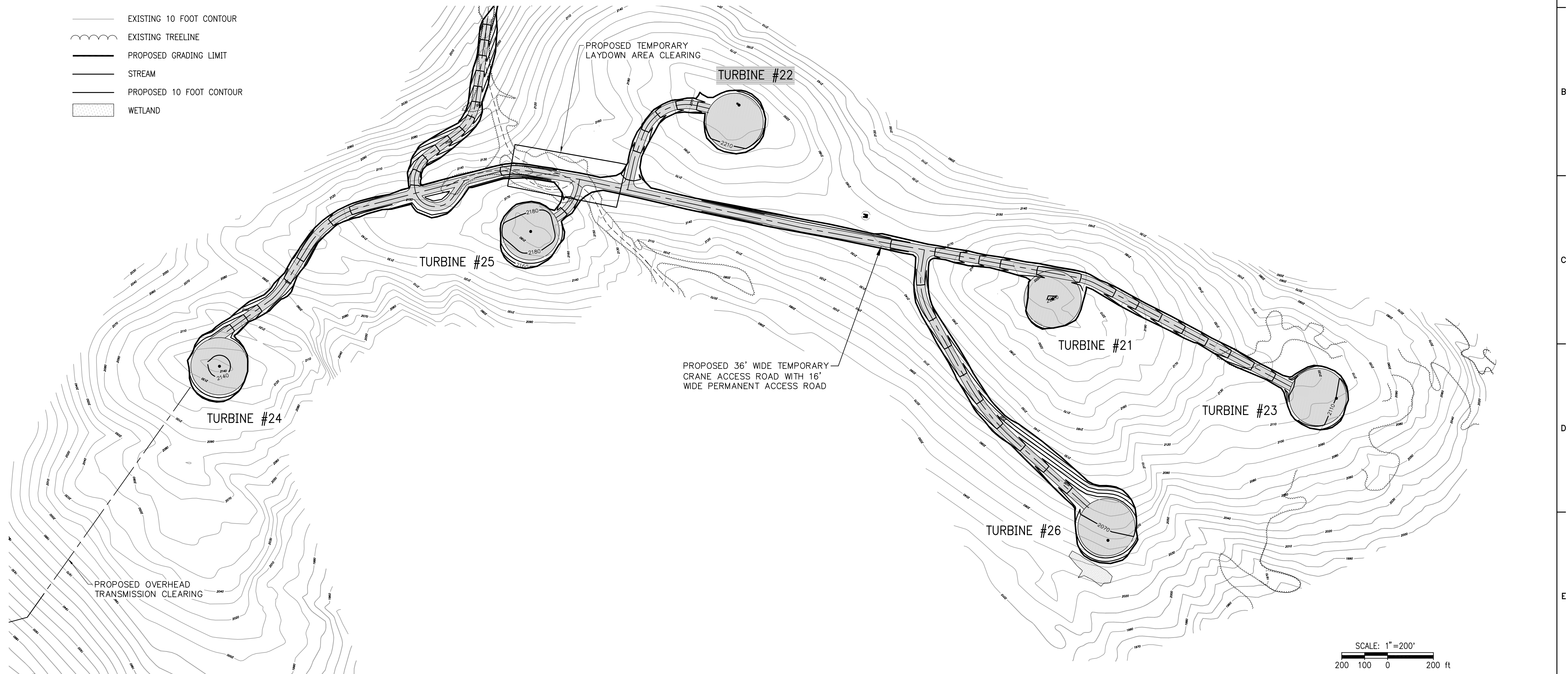

**Devine Tarbell & Associates, Inc.**  
Consulting Engineers, Scientists, & Regulatory Specialists

970 Baxter Boulevard  
Portland, Maine 04103

REFERENCE FILES/X-REFS.

BAR IS ONE INCH  
ON ORIGINAL  
DRAWING

IF NOT ONE  
INCH ON THIS  
SHEET ADJUST  
SCALE

NO	DATE	REVISION	DRN	DSGN	CHKD	APPR	CIVIL	ELEC	MECH
C	15FEB06	PROGRESS PRINT FOR REVIEW	JME	RDN					
B	09JAN06	PROGRESS REVIEW		RDN					
A	02NOV05	PROGRESS REVIEW	KK	RDN		RDN			

DRAWN BY:	CIVIL
J.EDWARDS	R.NELSON
DESIGNED BY:	MECHANICAL
CHECKED BY:	ELECTRICAL
APPROVED BY:	DATE:
	06APR05
PROJECT NO.	
100.0005.0100	

UPC VERMONT WIND, LLC. SHEFFIELD WIND FARM, SHEFFIELD, VT.	
PRELIMINARY PLAN @ SOUTHERN AREA	
SHEET 5 OF 5	
SCALE:	DRAWING NO.
1"=200'	C-101
REV.	C

K:\Wind Management, LLC \Sheffield Mountain (hand-drawable) Vermont\5.0 DESIGN AND STUDY CALCULATIONS\5.3 Working Drawings\All Edwards FEB06-REVIEW Drawing set\C-101\_Sheffield\5.dwg, 2/17/2006 1:05:51 PM, Last Edit: M.Hopkione